

MALDIVES LAND SURVEY AUTHORITY

MINISTRY OF HOUSING AND INFRASTRUCTURE

Office (PABX): +(960) 3004300, Fax: +(960) 3004254

Ameenee Magu, Maafannu, Male', 20392, Maldives.

Email: survey@housing.gov.mv

Web: www.surveyofmaldives.gov.mv,



CONTROLPOINT DETAILS	Station Number	PSM 5541
Coordinate Information		
Geodetic	Grid	
WGS 84	UTM Zone 43	
Lat: 4°41'29.59484"N	E:	328066.059
Long: 73°26'59.64443"E	N:	518759.580
Ellp Height:	Orth Height: +1.055	
Island Name: K OLHAHALI	Date: 11 OCTOBER 2018	

Monument description & method of survey:

- Established to Type A monument standard but instead of 300mm pipe , a wooden box (0.3m x 0.3m x 1m height)has been used.
- Stainless steel plate fixed to concrete by Four bolts - Horizontal coordinates fixed by GNSS Static survey.
- Elevation reduced relative to Local MSL by double level run
- PSM 5541 is 50mm above ground Level

General site condition & access:

- Easily accessible area with wide angle of sky visibility
- Located near near the

Owner: Grand Meridian Pvt Ltd.

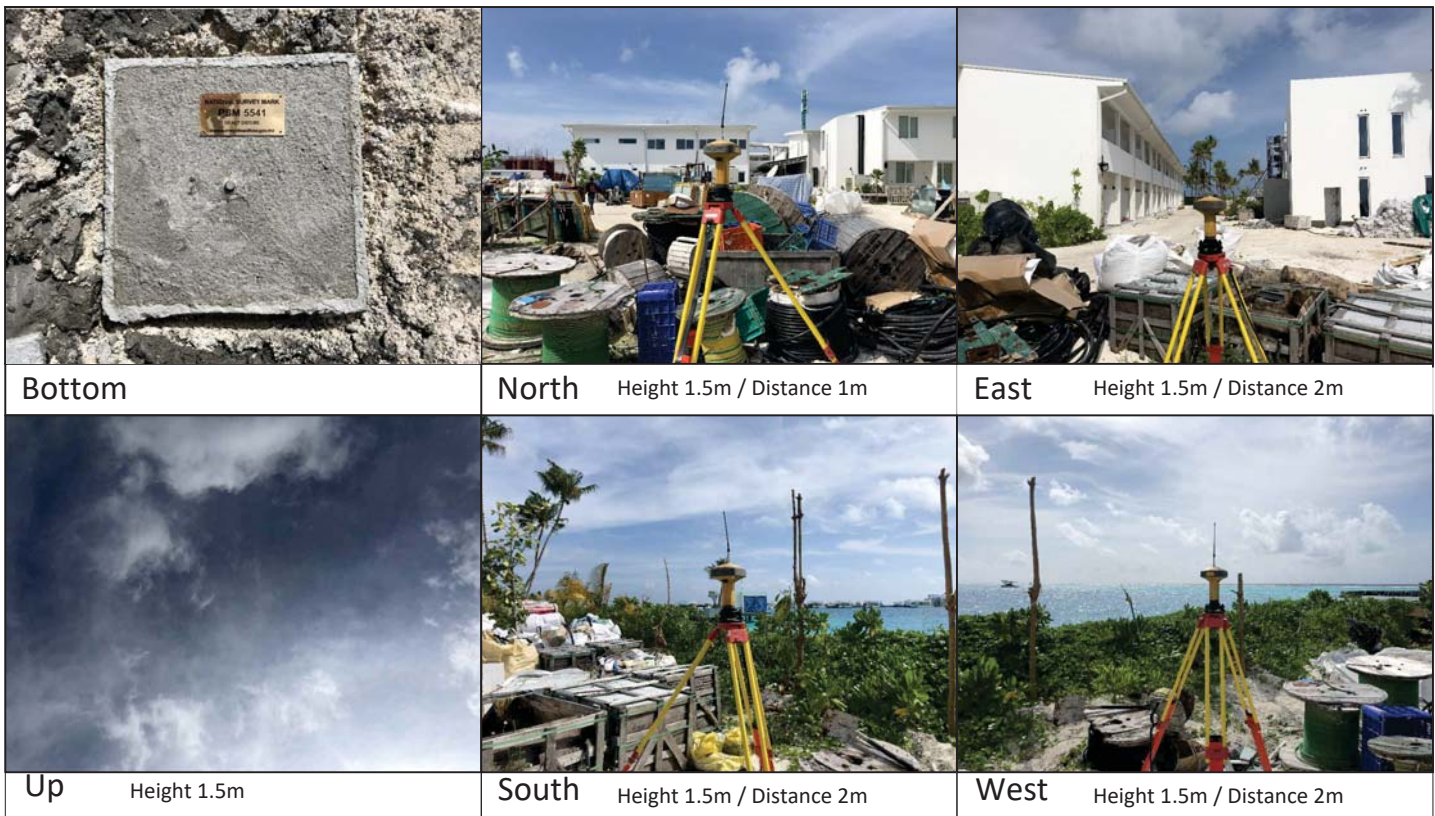

SITE INFORMATION

Station Number

P	S	M	5	5	4	1
---	---	---	---	---	---	---

Station Horizon Mask

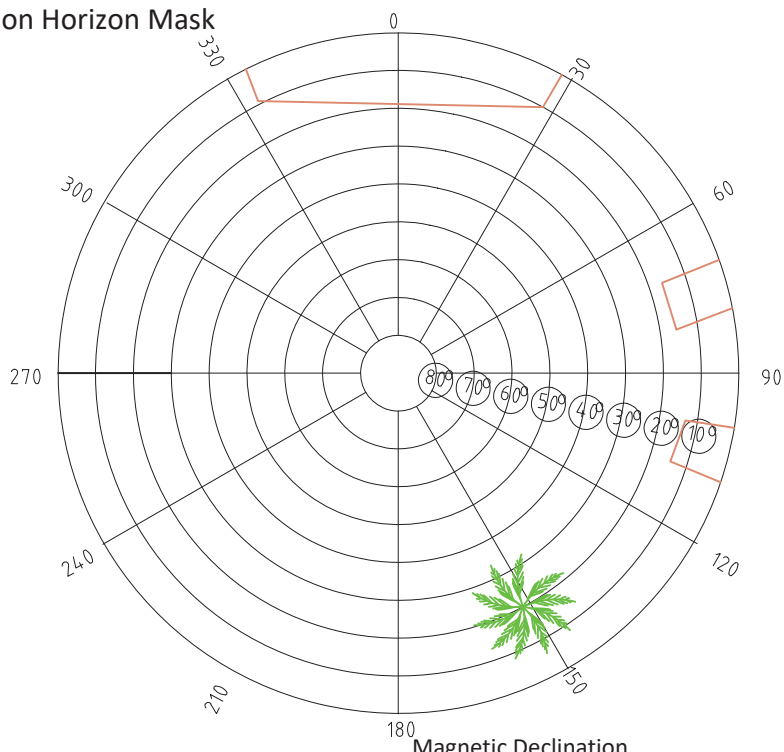

Height above Marker that horizon was mapped from 1.5 m

Magnetic Declination _____
 Declination applied to this figure?
 Yes No



Locality

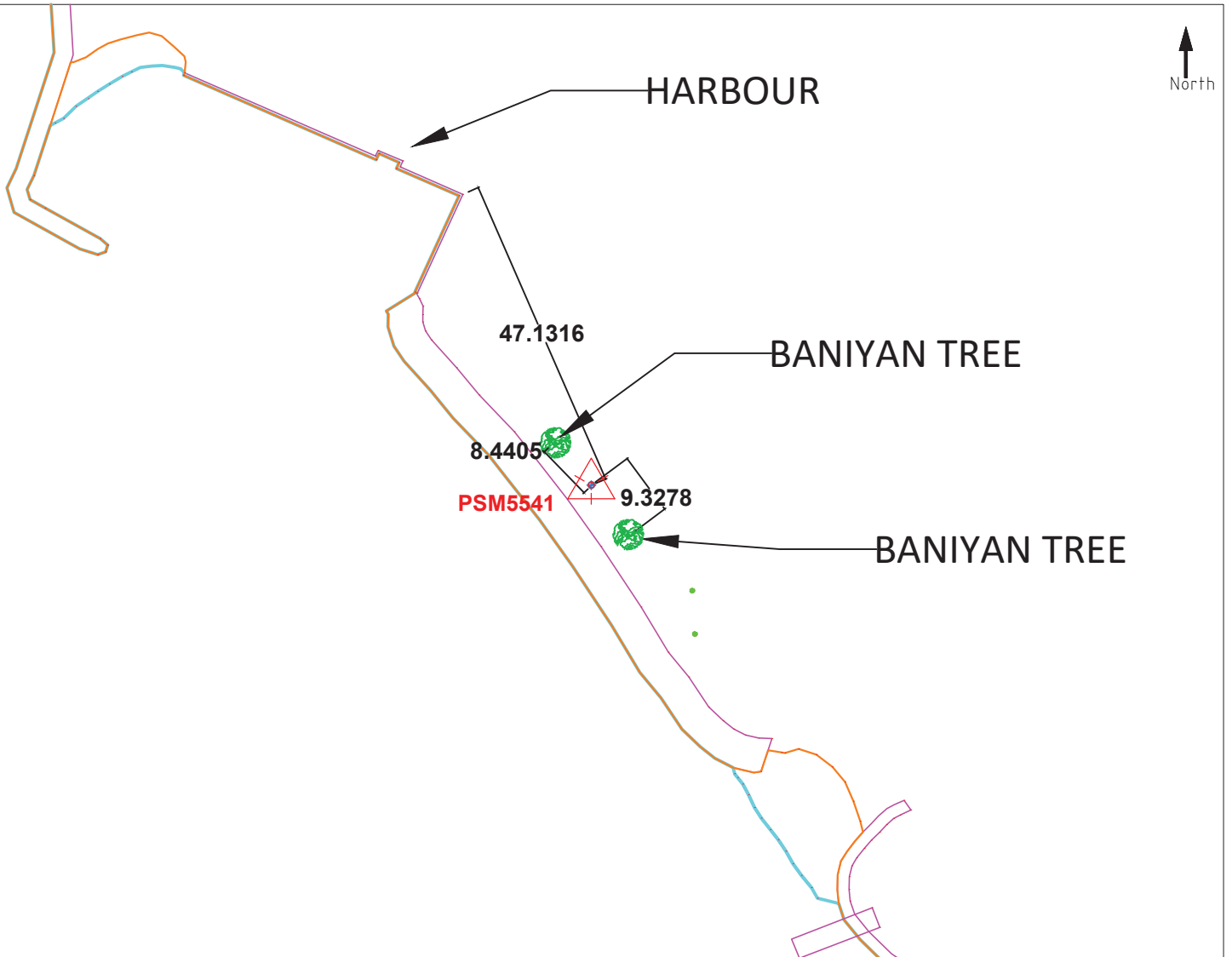
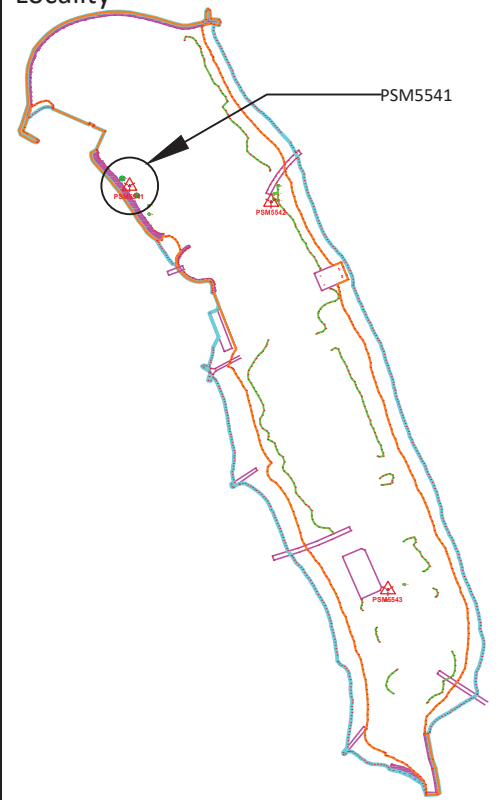

Sketched by: Abulho

Scale: Not to Scale

Date: 11 OCTOBER 2018

MALDIVES LAND SURVEY AUTHORITY

MINISTRY OF HOUSING AND INFRASTRUCTURE
 Office (PABX): +(960) 3004300, Fax: +(960) 3004254
 Ameenee Magu, Maafannu, Male', 20392, Maldives.
 Email: survey@housing.gov.mv
 Web: www. surveyofmaldives.gov.mv,



CONTROLPOINT DETAILS	Station Number	PSM 5542
Coordinate Information		
Geodetic	Grid	
WGS 84		
Lat: 4°41'29.19110"N	E:	328177.310
Long: 73°27'03.25526"E	N:	518746.933
Ellp Height:	Orth Height:	+1.149
Island Name: K OLHAHALI	Date:	11 OCTOBER 2018

Monument description & method of survey:

- Established to Type A monument standard but instead of 300mm pipe , a wooden box (0.3m x 0.3m x 1m height)has been used.
- Stainless steel plate fixed to concrete by Four bolts
- Horizontal coordinates fixed by GNSS Static survey.
- Vertical height corrected using tide prediction data
- PSM 5542 is 100mm above ground Level

General site condition & access:

- Easily accessible area with wide angle of sky visibility
- Located in vegetation line of the island

Owner: Grand Meridian Pvt Ltd.

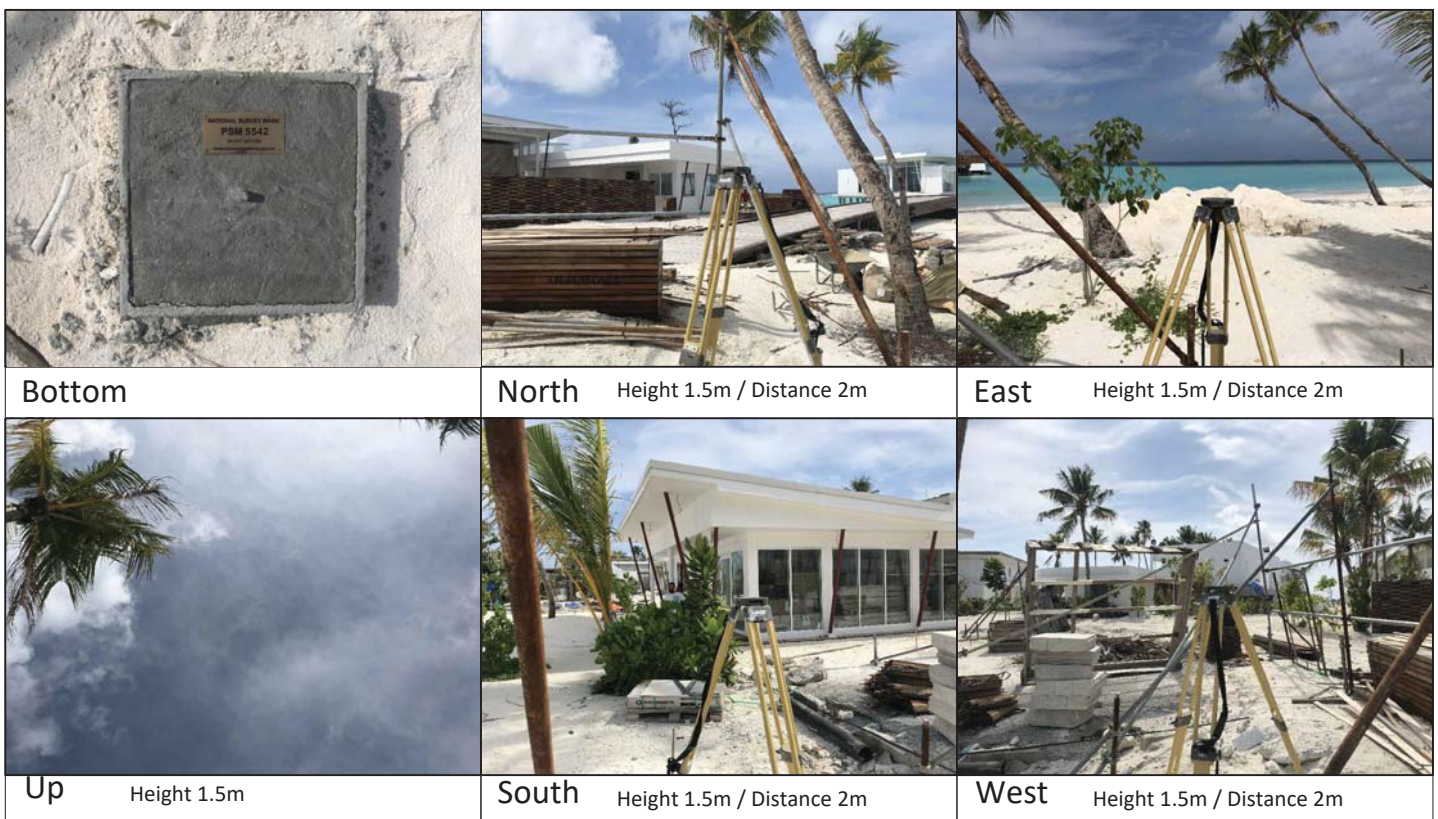

SITE INFORMATION

Station Number

P	S	M	5	5	4	2
---	---	---	---	---	---	---

Station Horizon Mask

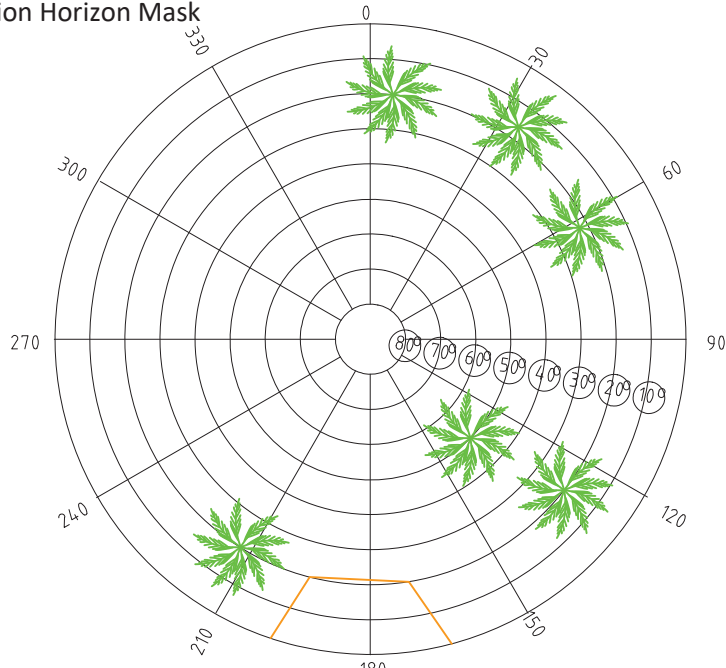

Height above Marker that horizon was mapped from 1.5 m

Magnetic Declination _____
 Declination applied to this figure?
 Yes No



Locality

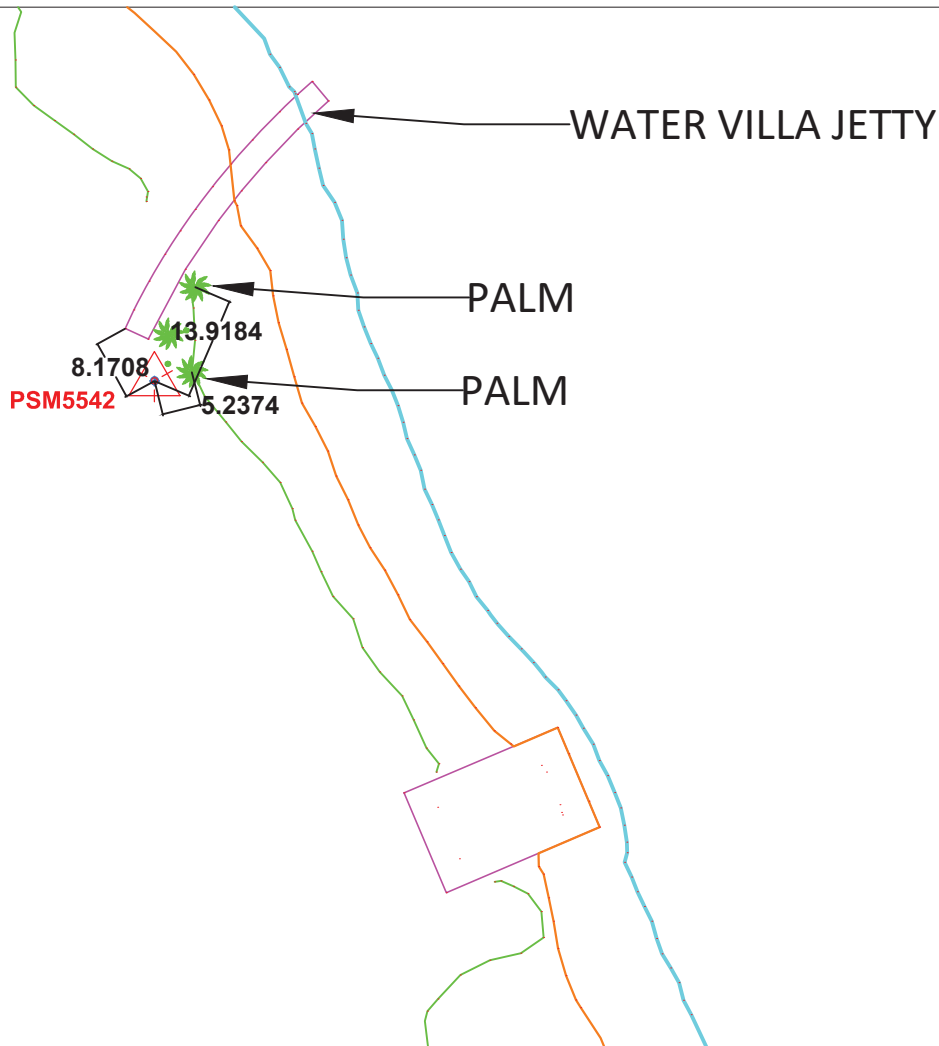

Sketched by: Abulho

Scale: Not to Scale

Date: 11 OCTOBER 2018

MALDIVES LAND SURVEY AUTHORITY

MINISTRY OF HOUSING AND INFRASTRUCTURE
Office (PABX): +(960) 3004300, Fax: +(960) 3004254
Ameenee Magu, Maafannu, Male', 20392, Maldives.
Email: survey@housing.gov.mv
Web: www.surveyofmaldives.gov.mv,



CONTROLPOINT DETAILS	Station Number	PSM 5543
Coordinate Information		
Geodetic	Grid	
WGS 84	UTM Zone 43	
Lat: 4°41'19.28686"N	E:	328268.948
Long: 73°27'06.25060"E	N:	518442.510
Ellp Height:	Orth Height:	+1.269
Island Name: K OLHAHALI	Date:	11 OCTOBER 2018

Monument description & method of survey:

- Established to Type A monument standard but instead of 300mm pipe , a wooden box (0.3m x 0.3m x 1m height)has been used.
- Stainless steel plate fixed to concrete by Four bolts
- Horizontal coordinates fixed by GNSS Static survey.
- Elevation reduced relative to Local MSL by double level run - PSM 5543 is 50mm above ground Level

General site condition & access:

- Easily accessible area with wide angle of sky visibility
- Located in vegetation line of the island

Owner: Grand Meridian Pvt Ltd.



Bottom



North Height 1.5m / Distance 2m



East Height 1.5m / Distance 2m

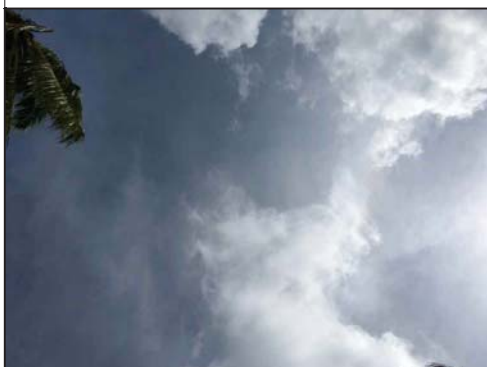

Up Height 1.5m



South Height 1.5m / Distance 2m



West Height 1.5m / Distance 2m

SITE INFORMATION

Station Number

P	S	M	5	5	4	3
---	---	---	---	---	---	---

Station Horizon Mask

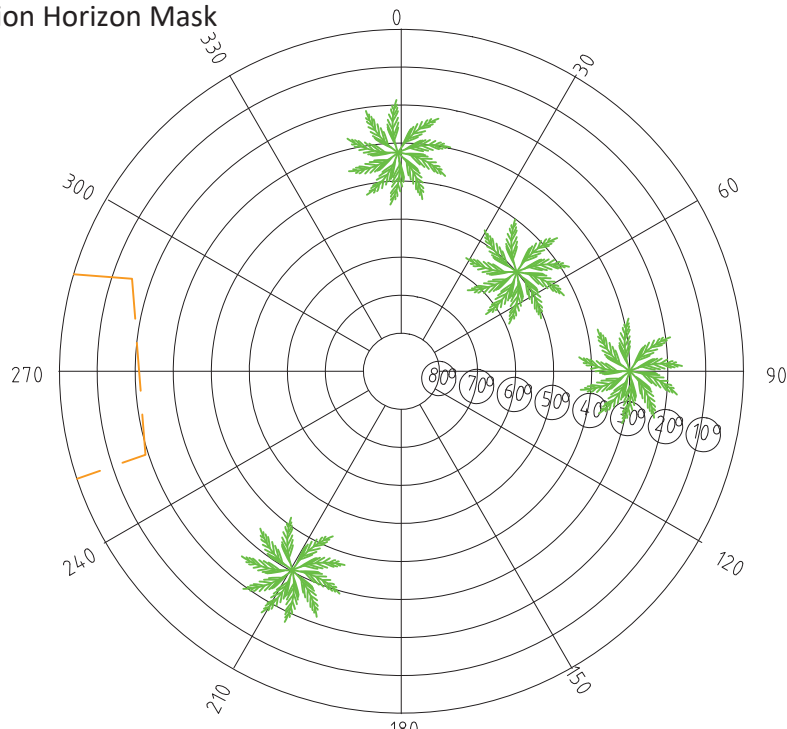

Height above Marker that horizon was mapped from 1.5 m

Magnetic Declination _____
 Declination applied to this figure?
 Yes No



Locality

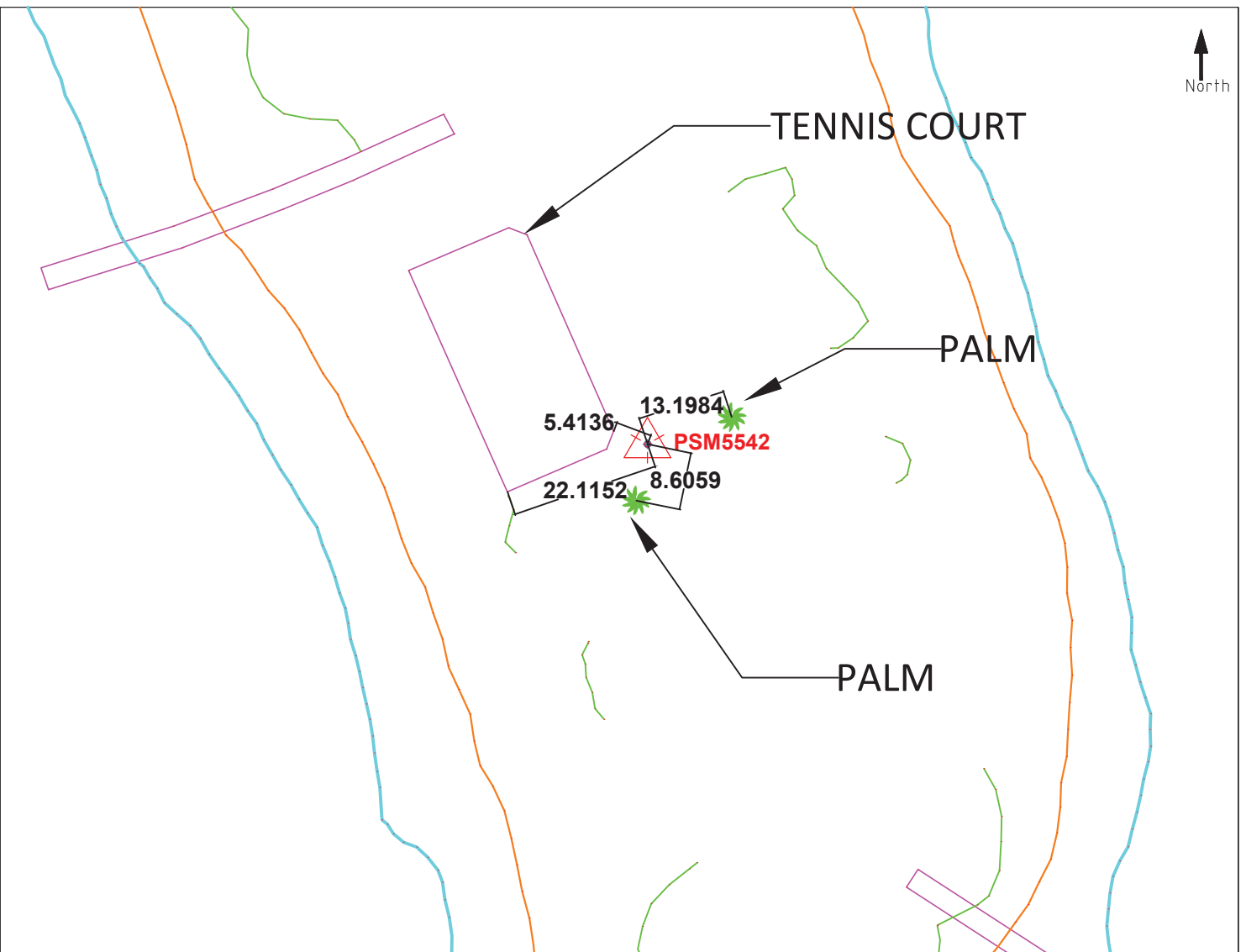

Sketched by: Abulho

Scale: Not to Scale

Date: 11 OCTOBER 2018